

FRIALEN®-Transition Fittings HDPE/Steel USTR PE 100 SDR 11

Maximum working pressure 10 bar (Gas)

d/DN 25/20-75/65

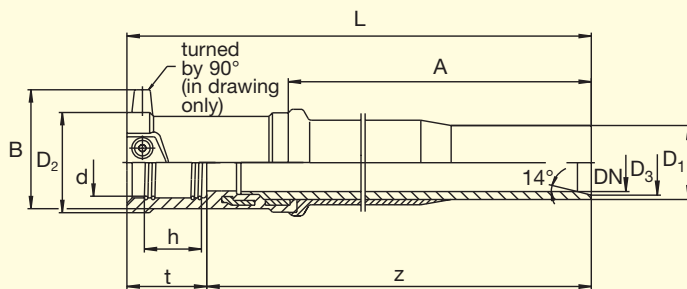

Beveled edge of the steel pipe: Design A steel pipes accord. to DIN 2442, wall thickness to DIN 2441
Design B steel pipes accord. to DIN 2470 (on stock)

d/DN 90/80-225/200

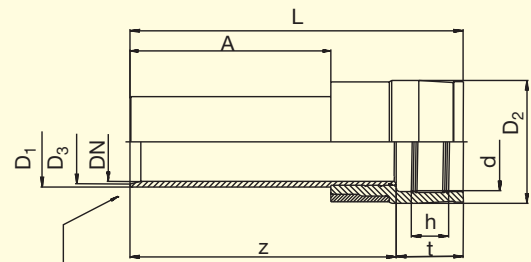

Beveled edge design B accord. to DIN 2470

d/DN	Order-Ref.	Stock-status	VE	PE	D ₁	D ₂	D ₃	L	A	t	z	h	B	Weight kg/each
25/20	T-612 744	1	20	600	26.9	40	20.8	376	300	36.5	339	19.5	-	0.835
32/25	T-612 780	1	15	450	33.7	47	28.0	388	300	42.0	346	23.5	61.0	1.185
40/32	T-612 781	1	10	300	42.4	58	36.5	396	300	45.5	351	30.0	69.5	1.604
50/40	T-612 782	1	8	240	48.3	70	42.5	409	300	53.0	356	29.8	80.0	2.100
63/50	T-612 783	1	6	180	60.3	84	54.5	410	300	53.0	357	35.0	93.5	2.720
75/65	T-612 789	1	4	120	76.1	98	70.2	425	300	61.0	364	37.5	-	4.200
90/80	T-612 784	1	1	84	88.9	118	82.5	397	250	71.5	326	42.8	-	5.225
110/100	T-612 785	1	1	54	114.3	143	107	420	250	83.0	337	47.0	-	8.380
125/100	T-612 786	1	1	46	114.3	158	107	425	250	84.5	341	51.0	-	8.800
160/150	T-612 787	1	1	24	168.3	197	161	484	250	119.5	365	88.7	-	16.830
180/150	T-615 030	1	1	18	168.0	227	161	500	250	115.0	385	67.4	-	21.250
200/200	T-612 795	1	1	12	219.1	267	211	481	225	116.0	365	70.7	-	27.020
225/200	T-612 370	1	1	11	219.1	282	211	459	225	120.0	339	70.2	-	27.350

FRIALEN®-Safety Fittings can be fused to pipes of SDR stages 11 to 17.6

DVGW-Registration Nos.: DV-7501AU2256, DV-7501AU2257 and DV-7501AU2258

Please turn over for important information regarding application of **FRIALEN®**-Transition Fittings USTR



FRIALEN[®]-Transition Fittings HDPE/Steel USTR

PE 100 SDR 11

Maximum working pressure 10 bar (Gas)

Areas of Application

FRIALEN[®]-Transition Fittings USTR are used for connection of HDPE house connection pipe to the steel pipe of the house entry fitting.

The larger dimensions connect an HDPE pipeline to a steel fitting or steel pipeline.

Assembly Instructions

Due to heat dissipation only arc welding is permissible.

The fusion of the HDPE side takes place by FRIALEN[®]-fusing – leakproof and longitudinally strong.

Welding of the steel end and fusion of the HDPE side have to be prepared according to the general installation instructions (see "Transition Fittings" in "Assembly Instructions" for "FRIALEN[®]-Safety Fittings for house connections and distribution pipes up to d 225"). This involves removing the oxide skin and cleaning the pipe ends.

Eight good reasons for using the FRIALEN[®]-USTR

- **Compact construction**
- **HDPE side with exposed heating element for optimal heat transfer**
- **Cold zones at the end to prevent the flow of molten material**
- **No holding clamps required**
- **Large insertion depth, extra wide fusion zones**
- **Steel end permanently anchored in the HDPE and will not distort**
- **Self sealing patented sealing geometry without elastomer seal**
- **Additional barcode for tracing back the underground fitting (Traceability-Coding).**

Please find our datasheets for downloading on the internet at www.friatec.de

For further information, please call our FRIALEN[®]-customer service staff and specialist advisers.