

FRIALEN®-Transition Elbows 90°**HDPE/Steel WUSTM 90°**

with internal thread

PE 100 SDR 11

Maximum working pressure 5 bar (Gas)

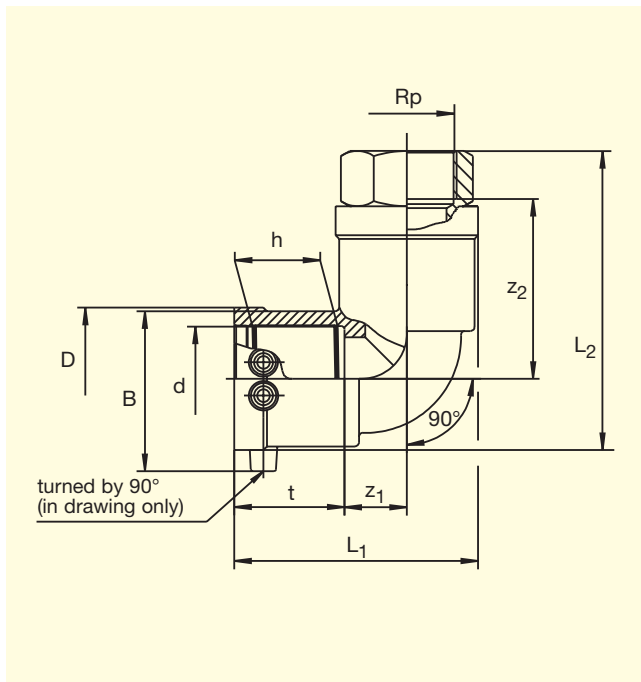

d	Rp ①	Order-Ref.	Stock-status	VE	PE	D	t	L ₁	L ₂	z ₁	z ₂	h	B	Weight kg/each
32	1"	T-612 610	1	20	1.000	47	42	85	111	21	49	23.5	61	0.368
40	1"	T-612 611	2	15	750	58	45.5	102	130	27	54.5	30	69.5	0.650
40	1 1/4"	T-612 612	1	15	750	58	45.5	102	130	27	53	30	69.5	0.540
50	1 1/2"	T-612 614	1	10	500	70	53	118	146	30	60	29.8	80	0.705
63	2"	T-612 616	1	10	320	84	53	128	161	33	60.5	35	93.5	1.115

① Other thread sizes on request

FRIALEN®-Safety Fittings can be fused to pipes of SDR stages 11 to 17.6.

DVGW-Registration Nos.: DV-7501AU2256 and DV-7501AU2257

Please turn over for important information regarding application of
FRIALEN®-Transition Elbows WUSTM 90°

FRIALEN[®]-Transition Elbows 90°

HDPE/Steel WUSTM 90°

with internal thread

PE 100 SDR 11

Maximum working pressure 5 bar (Gas)

Areas of Application

FRIALEN[®]-Transition Elbows WUSTM 90° are threaded joints as an adaptor from a metal pipe with external thread to a HDPE pipe. Joint on the part of HDPE by FRIALEN[®]-Coupler.

Assembly Instructions

The threaded component must be held with a spanner to prevent it twisting in the HDPE component.

The fusion of the HDPE side takes place by FRIALEN[®]-fusing – leakproof and longitudinally strong.

The installation of the steel and the HDPE side has to be prepared according to the general installation instructions (see "Transition Fittings with threaded connection" in "Assembly Instructions" for "FRIALEN[®]-Safety Fittings for house connections and distribution pipes up to d 225"). This involves removing the oxide skin and cleaning the pipe ends.

Eight good reasons for using the FRIALEN[®]-Transition Elbows WUSTM 90°

- **Compact construction**
- **HDPE side with exposed heating element for optimal heat transfer**
- **Cold zones at the end to prevent the flow of molten material**
- **No holding clamps required**
- **Large insertion depth, extra wide fusion zones**
- **Steel end permanently anchored in the HDPE and will not distort**
- **Self sealing patented sealing geometry without elastomer seal**
- **Additional barcode for tracing back the underground fitting (Traceability-Coding).**

Please find our datasheets for downloading on the internet at www.friatec.de

For further information, please call our FRIALEN[®]-customer service staff and specialist advisers.