

FRIALEN®-Slide-over Couplers UB PN25**PE 100 SDR 7,4**

Maximum working pressure 25 bar (water)

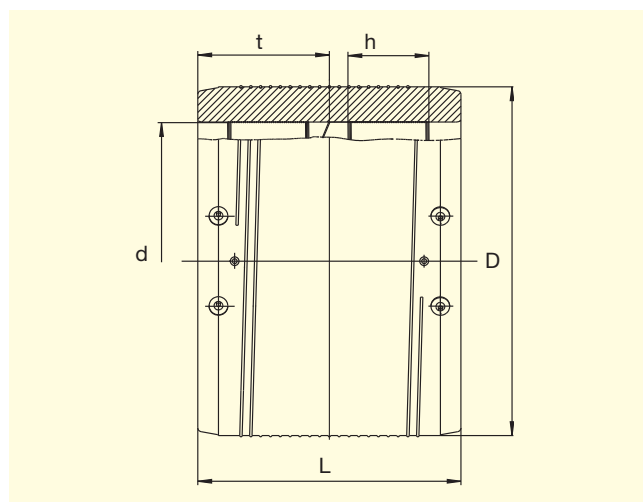
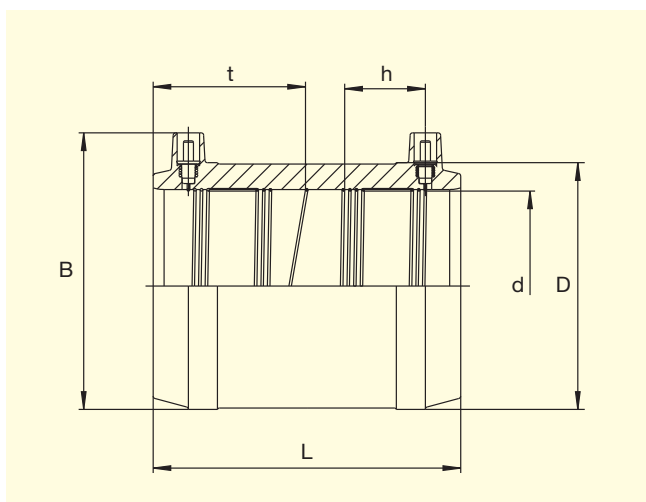

d	Order-Ref.	Stock-status	VE	PE	D	B	L	t	h	Weight kg/each
90	T-616 270	1	30	240	117	128	138	69	38	0,530
110	T-616 271	1	24	192	142	152	159	79	50	0,891
125	T-616 272	1	16	128	160	170	172	86	45	1,196
140	T-616 273	1	12	96	181	188	184	92	51	1,622
160	T-616 274	1	8	64	206	213	203	95	59	2,358
180	T-616 282	1	6	48	225	225	210	105	63	2,950
200	T-616 283	1	2	36	250	250	224	110	67	3,870
225	T-616 284	1	1	33	280	280	240	118	73	5,160
250	T-616 285	1	1	24	315	315	246	123	68	6,840
280 ^①	T-616 286	1	1	18	355	355	268	134	84	10,700
315 ^①	T-616 287	1	1	18	400	400	285	142	80	13,400
355 ^①	T-616 288	1	1	9	450	450	300	150	88	17,900

^① Separate fusion zones. From d 280 with pre-heating barcode for compensation of a larger annular gap. FRIALEN®-Safety Fittings can be fused to pipes of SDR stages 7,4 to 11

Please turn over for important information regarding application of FRIALEN® Slide-over Coupler UB PN25.

FRIALEN[®]-Slide-over Couplers UB PN25

PE 100 SDR 7,4

Maximum working pressure 25 bar (water)

Areas of Application

The FRIALEN[®]-Coupler UB PN25 is used for pipe connections when laying long runs.

Additional areas of application:

- Integration of adapters into an existing pipeline
- Connection of pipelines with fixed or restraint points
- Reinforcement / sealing of localised pipe damage
- Reinforcement of pinch points

Assembly Instructions

The fusion of pipe ends with the FRIALEN[®]-Coupler UB PN25 takes place using FRIALEN[®]-fusing – leakproof and longitudinally strong.

The pipe ends are prepared according to the general installation instructions (see “Assembly Instructions” for “FRIALEN[®]-Safety Fittings for house connections and distribution pipes up to d 225” and “FRIALEN[®]-Special Technology for laying large bore pipes and relining pipe networks”). This involves removing the oxide skin and cleaning the pipe ends. Please note that spigot of valves must be at least half as long as the coupler.

To compensate a larger annular gap (> 1 mm, max. 3 mm) between coupler and pipe, the pre-heating barcode can be used for couplers UB PN25 d 280 - d 355 (see instructions packed up with the coupler).

Twelve good reasons for using the FRIALEN[®]-Slide-over Coupler UB PN25

- Large coupler depth for ease of pipe guiding (no holding clamps required)
- Extra wide fusion zones
- Maximum stability through great wall thickness
- Cold zones at the front side and in the middle of the coupler
- Exposed heating coil for direct heat transmission to the pipe
- Small annular gap for build-up of optimum joining pressure in the fusion zone
- Contacts safe to touch
- Fusion indicators for visual fusion control
- From d280: unique pre-heating technique for an optimal gap-bridging
- Durable batch marking
- Individually wrapped for dirt protection
- Additional barcode for tracing back the underground fitting (Traceability-Coding).

Please find our datasheets for downloading on the internet at www.friatec.com

For further information, please call our FRIALEN[®] customer service staff and specialist advisers.