

FRIALEN®-Couplers MB

with removable stop

PE 100 SDR 11

Maximum working pressure 16 bar (Water) / 10 bar (Gas)

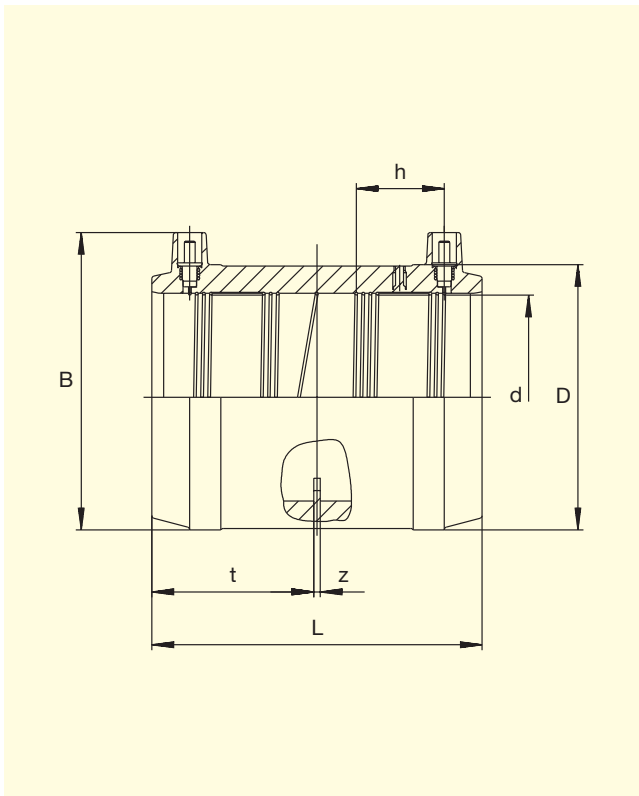

d	Order Ref.	Stock-status	VE	PE	D	B	L	t	z	h	Weight kg/each
20	T-612 680	1	80	4.000	33	49	60	29	2	17	0.037
25	T-612 681	1	60	3.000	38	55	66	32	2	18	0.045
32	T-612 682	1	30	1.500	45	61	78	38	2	21	0.073
40	T-612 683	1	20	1.000	54	71	86	42	2	23	0.096
50	T-612 684	1	12	600	68	82	98	48	2	27	0.151
63	T-612 685	1	5	250	82	96	112	55	2	29	0.212
75	T-612 686	1	20	360	98	110	122	60	2	24	0.324
90	T-612 687	1	30	240	114	130	138	68	3	41	0.436
110	T-612 688	1	24	192	137	152	159	78	3	48	0.705
125	T-612 689	1	16	128	156	169	172	85	3	51	0.946
140	T-612 690	1	12	96	174	185	184	91	3	52	1.275
160	T-612 691	1	8	64	199	207	190	94	3	52	1.772

FRIALEN®-Safety Fittings can be fused to pipes of SDR stages 11 to 17.6
DVGW-Registration Nos. DV-8601AU2248 and DV-8606AU2249

Please turn over for important information regarding application of
FRIALEN® Coupler MB.

FRIALEN[®]-Couplers MB

with removable stop

PE 100 SDR 11

Maximum working pressure 16 bar (Water) / 10 bar (Gas)

Areas of Application

The FRIALEN[®]-coupler MB is used for pipe connections when laying long runs. Additional areas of application:

- Integration of adapters into an existing pipe-line
- Connection of pipelines with fixed or restraint points
- Reinforcement / sealing of localised pipe damage
- Reinforcement of pinch points

Assembly Instructions

The fusion of pipe ends with the FRIALEN[®]-coupler MB takes place using FRIALEN[®]-fusing – leakproof and longitudinally strong.

The pipe ends are prepared according to the general installation instructions (see “Assembly Instructions” for “FRIALEN[®]-Safety Fittings for house connections and distribution pipes up to d 225”). This involves removing the oxide skin and cleaning the pipe ends. Please note that spigot of valves must be at least half as long as the coupler.

Eleven good reasons for using the FRIALEN[®]-Coupler MB

- **Large coupler depth for ease of pipe guiding (no holding clamps required)**
- **Extra wide fusion zones**
- **Maximum stability through great wall thickness**
- **Cold zones at the front side and in the middle of the coupler**
- **Exposed heating coil for direct heat transmission to the pipe**
- **Small annular gap for build-up of optimum joining pressure in the fusion zone**
- **Contacts safe to touch**
- **Fusion indicator for visual fusion control**
- **Durable batch marking**
- **Individually wrapped for dirt protection**
- **Additional barcode for tracing back the underground fitting (Traceability-Coding).**

Please find our datasheets for downloading on the internet at www.friatec.com

For further information, please call our FRIALEN[®] customer service staff and specialist advisers.