

# FRIALEN®-Flange T-Piece FLT

d/DN 110/80 – 225/80

**PE 100 SDR 11/\*PE 100 SDR 17**

Maximum working pressure 16 bar (water)

\*Maximum working pressure 10 bar (water)

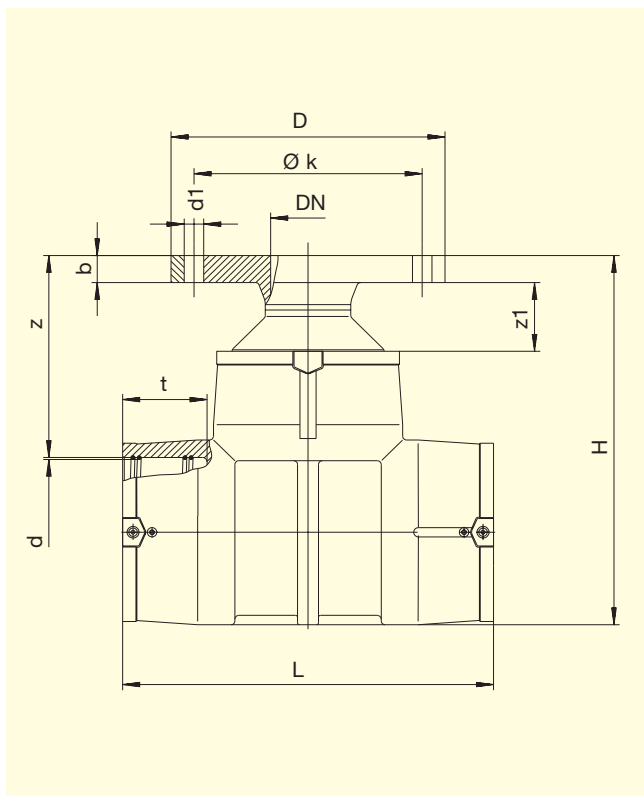

Supplementary washers are necessary

| d/DN    | Order Ref. | Stock-status | VE | PE | D   | Øk  | d <sub>1</sub> | z   | z <sub>1</sub> | b  | H   | t   | L   | Holes for screw. | Weight kg/each |
|---------|------------|--------------|----|----|-----|-----|----------------|-----|----------------|----|-----|-----|-----|------------------|----------------|
| 110/80  | T-615 590  | 1            | 4  | 32 | 204 | 160 | 16.5           | 180 | 90             | 25 | 336 | 87  | 355 | 8                | 4.880          |
| 125/80  | T-615 591  | 1            | 3  | 24 | 204 | 160 | 16.5           | 180 | 90             | 25 | 352 | 87  | 384 | 8                | 5.550          |
| 160/80  | T-615 592  | 1            | 2  | 16 | 204 | 160 | 16.5           | 210 | 70             | 25 | 390 | 96  | 430 | 8                | 9.100          |
| 180/80  | T-615 910  | 1            | 1  | 8  | 204 | 160 | 16.5           | 210 | -              | 25 | 415 | 103 | 480 | 8                | 10.000         |
| 225/80* | T-616 031  | 1            | 2  | 4  | 204 | 160 | 16.5           | 210 | -              | 25 | 465 | 118 | 580 | 8                | 15.420         |

FRIALEN®-Safety Fittings can be fused to pipes of SDR stages 11 to 17.6

DVGW-Registration Nos.: DV-8606AU2249 and DV-8611AU2250

Please turn over for important information regarding application of **FRIALEN®-Flange T-Piece FLT**



# **FRIALEN<sup>®</sup>-Flange T-Piece FLT**

**d/DN 110/80 – 225/80**

**PE 100 SDR 11/\*PE 100 SDR 17**

Maximum working pressure 16 bar (water)

\*Maximum working pressure 10 bar (water)

## **Areas of Application**

The FRIALEN<sup>®</sup> Flange T-Piece is used for the transition between HDPE pipes to pipes or valves made from metal.

The main area of application of the FRIALEN<sup>®</sup> Flange T-Piece is the hydrant connection.

## **Assembly Instructions**

The Flange T-piece is installed only in pressure-free condition.

Please refer to the FRIALEN<sup>®</sup>-Assembly Instructions with regard to the preparations of the T-piece in the direction of the passage opening with HDPE pipes (marking of insertion depth, removing oxide skin, cleaning, etc.) for FRIALEN<sup>®</sup> fusion.

Flange connection measurements correspond to DIN EN 1092-1. Supplementary washers are necessary.

All standard profile or flat gaskets can be used. Please observe screw torque specifications as indicated by the gasket manufacturer. We recommend G-ST gaskets.

## **Eight good reasons for using the FRIALEN<sup>®</sup>-Flange T-Piece FLT**

- **Compact part in HDPE**
- **Factory made combination made from FRIALEN<sup>®</sup> T-Piece, Reducer and Weld in flange (fixed flange)**
- **No inner fusion ridge on the fused seam of the reducer**
- **No "cold-flow characteristics" at the flange due to constructive design**
- **Short dimensions with regard to height and length**
- **Particularly economical solution**
- **T-Piece with exposed heating coils for optimal heat transfer, large insertion depth, wide fusion zones plus cold zones at the end and in the middle to prevent the flow of molten material**
- **Additional barcode for tracing back the underground fitting (Traceability-Coding).**

Please find our datasheets for downloading on the internet at [www.frialen.de](http://www.frialen.de)

**For further information, please call our FRIALEN<sup>®</sup>-customer service staff and specialist advisers.**