

# FRIALEN® Electrofusion Reducers MR

## PE 100 SDR 11

Maximum working pressure 16 bar (water) / 10 bar (gas)

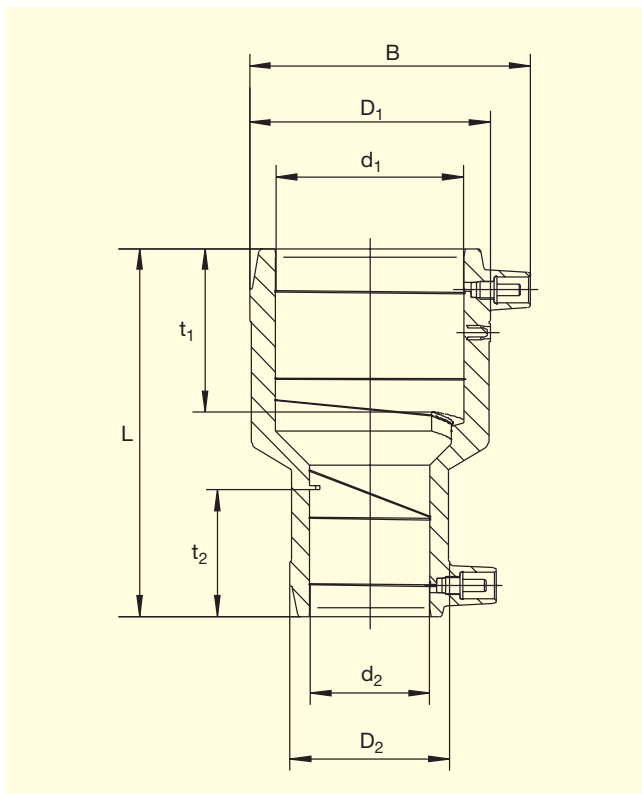

$d_1$	$d_2$	Order Ref.	Stock-status	VE	PE	$D_1/D_2$	B	L	$t_1$	$t_2$	Weight kg/each
32	20	T-615-386	1	40	2.000	45/ 32	62	88	39	30	0.055
32	25	T-615 502	1	30	1.500	45/ 38	62	88	39	33	0.060
40	20	T-615 387	1	30	1.500	54/ 32	70	98	43	30	0.075
40	32	T-615 388	1	25	1.250	54/ 45	70	98	43	39	0.093
50	20	T-612 069	1	16	800	68/ 32	82	110	49	37	0.133
50	32	T-612 070	1	16	800	68/ 45	82	110	49	39	0.143
50	40	T-612 071	1	12	600	68/ 54	82	110	49	43	0.142
63	32	T-615 389	1	8	400	82/ 45	96	125	55	44	0.217
63	40	T-615 390	1	8	400	82/ 54	96	125	55	43	0.224
63	50	T-612 072	1	8	400	82/ 68	96	125	55	48	0.237
90	50	T-615 391	1	15	270	117/ 68	129	160	69	49	0.485
90	63	T-615 392	1	15	270	117/ 82	129	160	69	55	0.510
110	63	T-615 393	1	10	180	142/ 82	152	160	79	55	0.729
110	90	T-615 693	1	8	144	140/115	152	180	79	69	0.900
125	90	T-615 694	1	8	144	155/115	166	200	86	69	0.980
160	110	T-615 695	1	8	64	201/140	207	230	98	79	1.990

FRIALEN®-Safety Fittings can be fused to pipes of SDR stages 11 to 17.6  
 DVGW-Registration Nos. DV-8601AU2248 and DV-8606AU2249

Please turn over for important information regarding application of **FRIALEN®** Electrofusion Reducers MR.



# **FRIALEN<sup>®</sup> Electrofusion Reducers MR**

## **PE 100 SDR 11**

Maximum working pressure 16 bar (water) / 10 bar (gas)

### **Areas of Application**

The FRIALEN<sup>®</sup> Electrofusion Reducer MR is applied for immediate pipe reduction within the pipe system.

### **Assembly Instructions**

Fusing of pipe ends with the FRIALEN<sup>®</sup> Electrofusion Reducers MR takes place by FRIALEN<sup>®</sup> fusion – leakproof and longitudinally strong.

The pipe ends are prepared according to the general installation instructions (note “Assembly Instructions” for FRIALEN<sup>®</sup> Safety Fittings for house connections and distribution pipes (Remove oxide skin/clean).

### **Eleven good reasons for using the FRIALEN<sup>®</sup> Electrofusion Reducers MR**

- Large coupler depth for ease of pipe guiding (no holding clamps required)
- Extra wide fusion zones
- Maximum stability through great wall thickness
- Cold zones at the front side and in the middle of the coupler
- Exposed heating coil for direct heat transmission to the pipe
- Small annular gap for build-up of optimum joining pressure in the fusion zone
- Contacts safe to touch
- Fusion indicator for visual fusion control
- Durable batch marking
- Individually wrapped for dirt protection
- Additional barcode for tracing back the underground fitting (Traceability-Coding).

Please find our datasheets for downloading on the internet at [www.friatec.de](http://www.friatec.de)

**For further information, please call our FRIALEN<sup>®</sup> customer service staff and specialist advisers.**