

SALES & ENGINEERING DATA

RATIO SERIES: **1:1**

FLUID P.S.I. RANGE: **10 - 100**

PD07R-XAS-XXX

3/4" METALLIC DIAPHRAGM PUMP

RELEASED: 12-4-06
 REVISED: 2-21-07
 (REV. 02) S-1410

DIMENSIONAL DATA

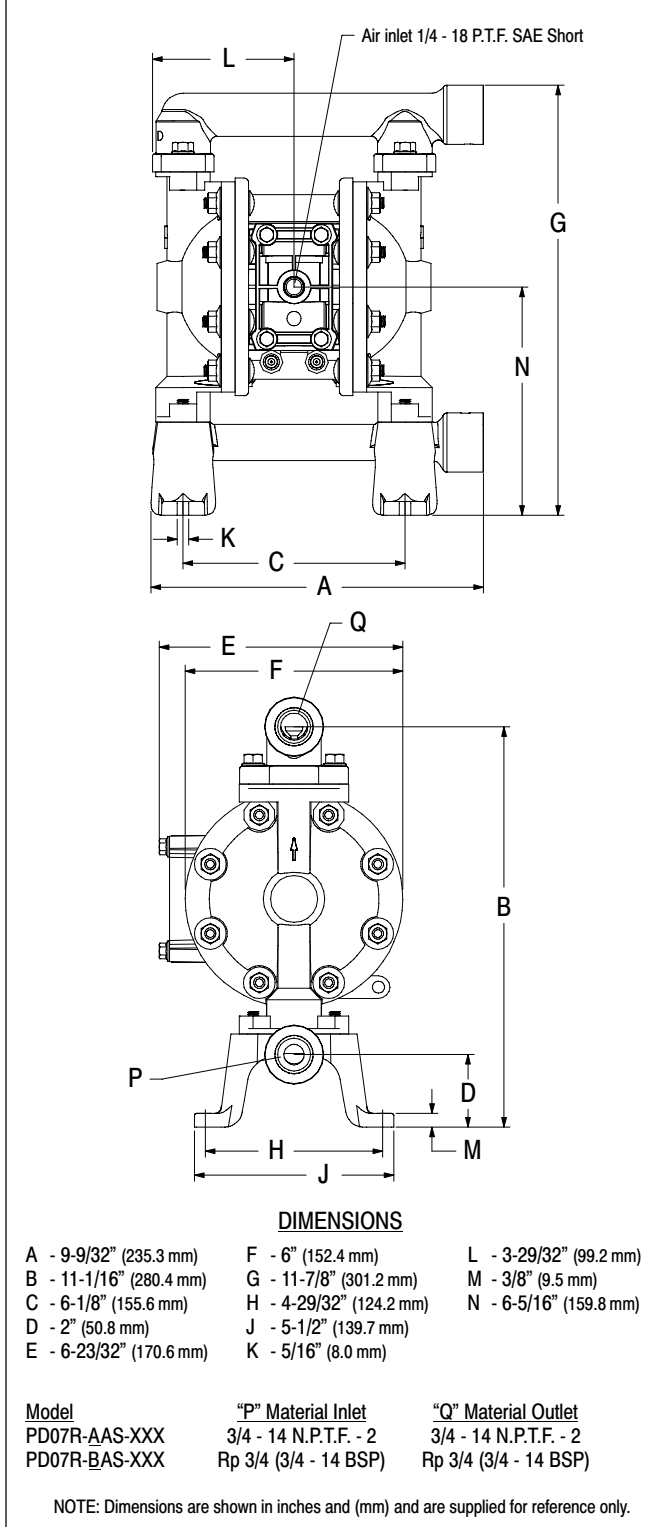

SPECIFICATIONS

CONSTRUCTION

Model Series PD07R-XAS-XXX
Pump Type Metallic, Air Operated, Double Diaphragm
Ratio 1:1
Material Inlet / Outlet (female)
 PD07R-AAS-XXX 3/4 - 14 N.P.T.F. - 2
 PD07R-BAS-XXX Rp 3/4 (3/4 - 14 BSP parallel)
Air Inlet (female) 1/4 - 18 P.T.F. SAE short
Air Exhaust (standard) internal
 (optional)(female) 3/8 - 18 N.P.T.F. - 1
Weight 8.74 lbs (3.96 kgs)
Air Section Service Kit 637428
Fluid Section Service Kit 637427-XX

PD07R-XAS- X X X
637427 - X X X
 Diaphragm Material
 Ball Material
 EXAMPLE: Model #PD07R-AAS-PCC
 Fluid Section Service Kit is 637427-CC

PERFORMANCE

Air Inlet Pressure Range 10 - 100 p.s.i. (0.69 - 6.9 bar)
Maximum Material Inlet Pressure ... 10 p.s.i. (0.69 bar)
Fluid Outlet Pressure Range 10 - 100 p.s.i. (0.69 - 6.9 bar)
Maximum Flow Rate (flooded inlet) .. 13.6 g.p.m. (51.5 l.p.m.)
Displacement / Cycle @ 100 p.s.i. .. 0.030 gal. (0.11 lit.)
Maximum Particle Size 3/32" dia. (2.4 mm)
Maximum Temperature Limits (diaphragm / ball / seat material)
 Hytel -20° to 150° F (-29° to 66° C)
 Polypropylene 35° to 150° F (2° to 66° C)
 Santoprene -40° to 225° F (-40° to 107° C)
 Teflon PTFE 40° to 225° F (4° to 107° C)
Noise Level @ 70 p.s.i. - 60 c.p.m.① . 75.0 db(A)②

Notes:

- ① Tested with 67367 muffler assembly installed.
- ② The pump sound pressure level has been updated to an Equivalent Continuous Sound Level (L_{Aeq}) to meet the intent of ANSI S1. 13-1971, CAGI-PNEUROP S5.1 using four microphone locations.

ACCESSORIES:

66073-1 Air Line Connection Kit
 637438 Ported Exhaust Kit
 93110 Muffler



PERFORMANCE CURVES

PD07R-XAS-XXX 3/4" METALLIC DIAPHRAGM PUMP

