

NPT Top Entry Valves

NPT Valve Dimensions

ANSI 300 Class NPT Top Entry Valves

Size	A	B	C	D	E	F
1/2"	0.81	2.15	4.29	3.48	5.15	1.70
3/4"	0.81	1.96	3.91	3.48	5.15	1.70
1"	0.81	1.96	3.91	3.48	5.15	1.70
1-1/2"	1.17	2.49	4.98	4.17	5.94	1.96
2"	1.50	2.86	5.72	4.74	7.87	2.22
3"	2.25	4.15	8.29	6.60	19.12	2.93

ANSI 600 Class NPT Top Entry Valves

Size	A	B	C	D	E	F
1/2"	0.81	2.37	4.73	4.93	8.50	1.92
3/4"	0.81	2.18	4.35	4.93	8.50	1.92
1"	0.81	2.18	4.35	4.93	8.50	1.92
1-1/2"	1.17	2.62	5.23	5.83	12.50	2.14
2"	1.50	2.99	5.98	6.63	14.75	2.54

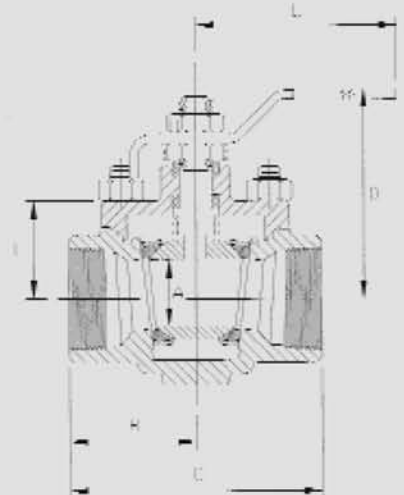
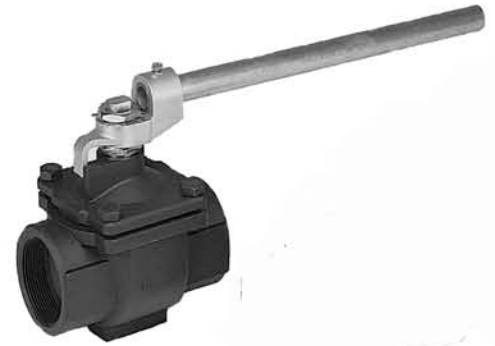

Top Entry Valves

How To Specify Apollo Top Entry Ball Valves

0 0 - 0 0 0 - 0 0

BODY MATERIAL

A - Alloy 20
 B - CF3M SS
 (Flanged)
 C - Carbon Steel
 F - Inconel
 H - Hastelloy C
 M - M35-1
 N - Nickel
 S - 316 SS
 T - Titanium

TRIM MATERIAL

A - Alloy 20
 B - 316L SS
 D - Hastelloy C Stem M35-1
 Ball
 E - 410 SS
 F - Inconel
 H - Hastelloy C
 M - M35-1 (Monel)
 N - Nickel
 S - 316 SS
 T - Titanium

END CONFIGURATION AND PRESSURE CLASS

B - 150# Flanged
 C - 300# Flanged
 D - 300# NPT
 E - 150# FP Flange
 F - 300# FP Flange
 G - 300# NPT x Soc. Weld
 H - 600# NPT
 J - 600# Socket Weld
 K - 600# Flanged
 L - 300# FP NPT
 M - 300# FP Soc. Weld
 N - 300# Socket Weld
 P - 300# Butt weld
 Q - 600# NPT x Soc. Weld
 R - 300# FLG x Butt weld
 S - 300# RTJ Flanges
 T - 600# FP Socket Weld
 U - 600# FP Flange
 W - 600# Butt weld
 Y - 300# FP NPT x Socket Weld
 3 - 300# FP Butt weld
 4 - 600# FP NPT
 6 - 600# FP NPT x Socket Weld
 7 - 600# FP Butt weld
 9 - 900# Flange

SEAT (FIGURES ON PAGE 15)

1 - TFE (Figure 1)
 2 - RTFE (Figure 1)
 3 - RTFE Seat (Figure 2)
 4 - Carbon Graphite -750°F max.
 (Figure 1)
 5 - 55% Bronze, 5% Moly, (Figure 2)
 6 - UHMWPE (Figure 2)
 7 - API-607 Certified (TFE Seat, TFE
 O-ring, Grafoil® Seal & Pkgs.)
 8 - PEEK (Figure 2)
 9 - Ceramic
 A - API-607 Certified (RTFE Seat,
 TFE O-ring, Grafoil® Seal &
 Pkgs.)
 B - 30% Carbon Reinforced PEEK
 (Figure 2)
 C - PFA (Figure 2)
 D - SRTFE, 60% SS, 40% TFE by
 weight (50% SS Min) (Figure 2)
 F - CRTFE (Figure 1)
 G - PCTFE (Figure 1)
 H - High Temp Graphite-1000°F max.
 (Figure 1)
 K - Stellite Ball & Seats (Figure 4)
 M - Malcomized 316 SS Ball & Seats
 (Figure 4)
 U - UHMWPE (Figure 1)

SIZE

3 - 1/2"
 4 - 3/4"
 5 - 1"
 7 - 1-1/2"
 8 - 2"
 0 - 3"
 A - 4"
 C - 6"
 E - 8"
 G - 10"
 H - 12"

OPTIONAL FEATURES

AR - Actuator Ready
BO - Grafoil® Seals & Packings
BN - TFE Spiralwound Bonnet Gasket
BS - Grafoil® Spiral Wound Bonnet
 Gasket & Grafoil® Packings
CH - Clamp-On Steam Jacket - Stainless
 Steel
CJ - Clamp-On Steam Jacket - Carbon Steel
CL - Cam-Lock Handle
EB - Extended Bonnet
EO - Round Handle
FC - Live Loaded Fugitive Emission w/
 Double RPTFE Chevron Packings
FG - Fugitive Emission Bonnet with EVSP®
 9000 Graphite Stem Packing
FL - Fugitive Emission Bonnet with Double
 RPTFE Stem Packing

FO - Full Jacketed w/Oversize Flanges
FP - Live Loaded Fugitive Emission w/Double
 EVSP Packings
GO - 2 1/4" Stem Extension
HH - Vented Body
HO - Vented Body & Cleaned for
 Chlorine Service
HP - Vented Body & Cleaned for Hydrogen
 Peroxide Service
***MG** - Gear Operator
MT - 2 Position Lock Plate
 for Standard Bonnet
MU - 2 Position Lock Plate for Extended
 Bonnet
NC - NACE Certified Trim
OL - Oval Locking Handle
OO - RPTFE Seals & Packings

OM - RPTFE Bonnet Gasket & UHMWPE
 Packings
PJ - Partial Steam Jacket
PO - Cleaned for Oxygen Service
PP - Cleaned for Industrial Gases
RS - Welded Ball Stop with Safety Cap
TP - Two Position Sliding Latch Lock Lever
ZO - PTFE Seals & Packings

NOTE: Optional Features may be used alone or in
 combination (simply added in alphabetical
 order), however not all combinations are
 available on all valves. This is a very
 limited list of the available options.
 Contact the factory for specific
 requirements and availability.

* MG Is Generic for Gear Operators. Contact Factory
 or Price Book for Specific Application and Part No.

© EVSP is a registered trademark of Garlock.