



# CPVC PIPE HANGERS

BUILDING CONNECTIONS THAT LAST



# BUILDING CONNECTIONS THAT LAST

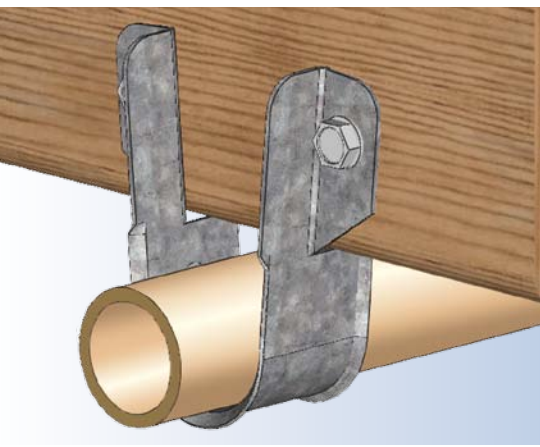

For over 150 years, Anvil has worked diligently to build a strong, vibrant tradition of making connections — from pipe to pipe and people to people.

We pride ourselves in providing the finest-quality pipe products and services with integrity and dedication to superior customer service at all levels.

We provide expertise and product solutions for a wide range of applications, from plumbing and mechanical, HVAC, industrial and fire protection to mining, and oil and gas. Our comprehensive line of products includes: grooved pipe couplings, grooved and plain-end fittings, valves, cast and malleable iron fittings, forged steel fittings, steel pipe nipples and couplings, pipe hangers and supports, channel and strut fittings, mining and oil field fittings, along with much more.

As an additional benefit to our customers, Anvil offers a complete and comprehensive Design Services Analysis for mechanical equipment rooms, to help you determine the most effective and cost-efficient piping solutions for your pipe system.

Anvil is a proud member of the United States Green Building Council (USGBC). Go to the Anvil website to obtain manufacturer recycled certificates and other green information.

At Anvil, we believe that responsive and accessible customer support is what makes the difference between simply delivering products — and delivering solutions.

**Size Range:** 3/4" through 2"

**Finish:** Galvanized steel

**Service:** Hanger for CPVC pipe in the horizontal position on the side of structural wood beams and Steel 20 Ga. (min) with hanger tab in the upward position only (Fig. A). It can also be used as a guide to limit movement of vertical CPVC pipe with the tab in the horizontal position.

**Approvals:** UL listed.

**Features:**

- Beveled edge design helps protect the CPVC pipe from any rough surface.
- Easily attaches to wood structure with #10 x 1" hex washer head self threading screw supplied with product. No pre-drilling required.

**Ordering:** Specify CPVC pipe size, figure number and description.

- Steel applications require one (1) #14 x 1" hex washer head self-drilling TEK screw. Not Supplied. Part Number STD-0090.

**Installation:**

- Place hanger over pipe.
- Secure hanger to mounting surface with screws provided.

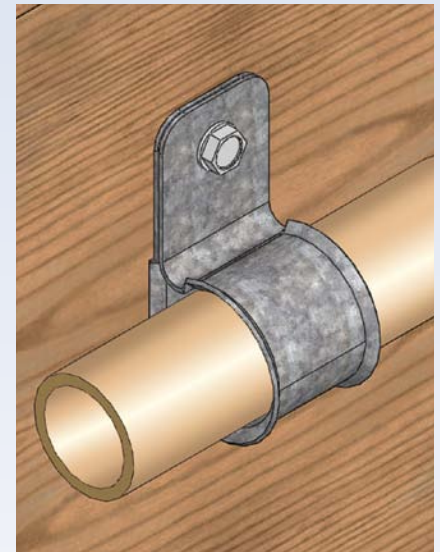
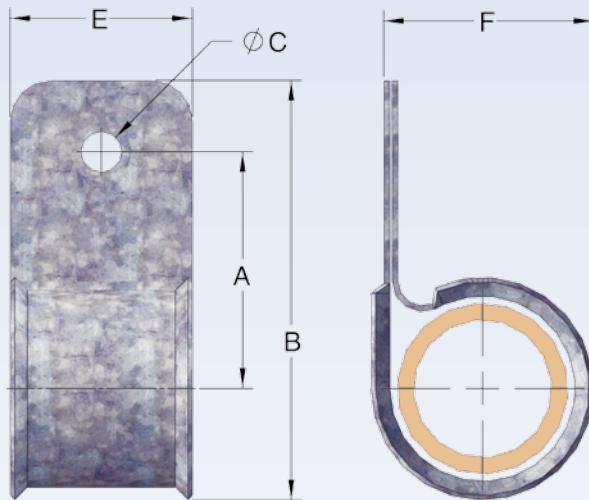

Fig. A

**FIG. 185: WEIGHT (LBS) • DIMENSIONS (IN)**

CPVC Pipe Size	Item Number	A	B	ØC	E	F	Max. Hanger Spacing (FT.)	Box Quantity		Approx. Weight/100 (lbs)
								Small	Master	
3/4	0560084006	1 1/16	2 1/2	1/4	1 1/8	1 1/4	5 1/2	50	200	8
1	0560084014	1 3/4	2 7/8	1/4	1 1/8	1 1/2	6	50	150	9
1 1/4	0560084022	1 11/16	3	1/4	1 1/8	1 3/8	6 1/2	50	100	10
1 1/2	0560084030	1 7/8	3 1/16	1/4	1 1/8	2 1/8	7	50	100	12
2	0560084048	2	3 3/8	1/4	1 1/8	2 5/8	8	50	100	14

# Figure 186 - Two Hole Pipe Strap

**Size Range:** 3/4" through 2"

**Finish:** Galvanized steel

**Service:** Hanger for CPVC pipe in the horizontal position on the bottom and side of structural wood beams, composite beams and Steel 20 Ga. (min.) (Fig. A, C respectively). Can be used as a restrainer when installed on top of structural wood beams (Fig. B), for limiting pipe movement due to thrust loads during sprinkler system start-up. It can also be used as a guide to limit movement for pipe in the vertical position. When used on composite wood beams, web thickness must be 3/8" or greater.

**Approvals:** UL listed.

**Features:**

- Dimples secure hanger to pipe for quick installation.
- Beveled edge design helps protect the CPVC pipe from any rough surface.
- Easily attaches to wood structure with #10 x 1" hex washer head self threading screw supplied with product. No pre-drilling required.

**Ordering:** Specify CPVC pipe size, figure number and description.

- Steel applications require two (2) #14 x 1" hex washer head self-drilling TEK screws. Not Supplied. Part Number STD-0090.

**Installation:**

- Snap hanger over pipe. Dimples will prevent hanger from falling off pipe.
- Secure hanger to mounting surface with screws provided.
- Do not make adjustments to hanger mounting flanges that result in clamping the pipe to the mounting surface. Pipe must be allowed to move freely through hanger.

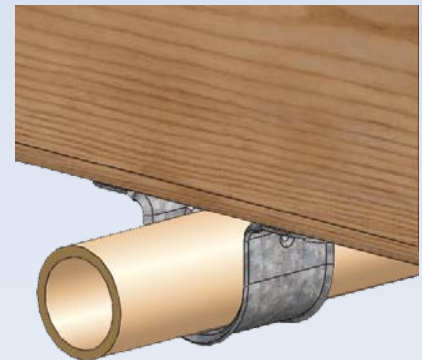

Fig. A

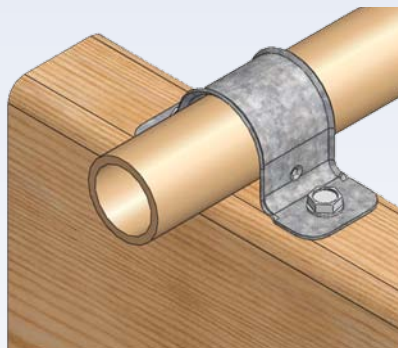
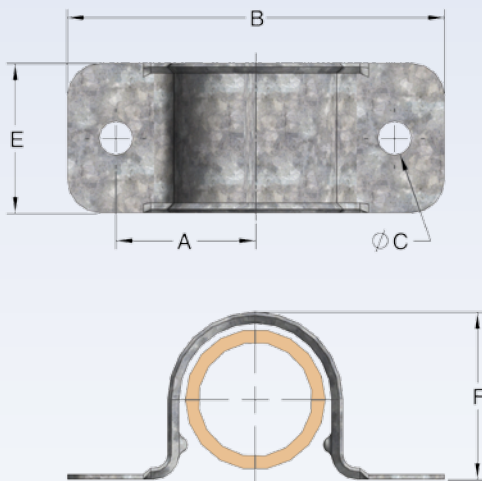

Fig. B

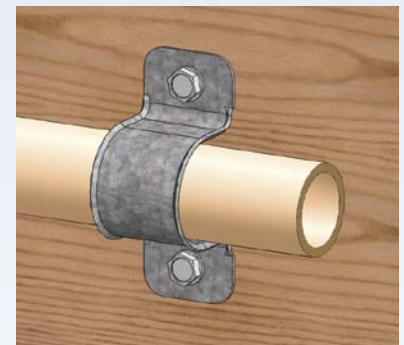

Fig. C

**FIG. 186: WEIGHT (LBS) • DIMENSIONS (IN)**

CPVC Pipe Size	Item Number	A	B	øC	E	F	Max. Hanger Spacing (FT.)	Box Quantity		Approx. Weight/100 (lbs)
								Small	Master	
3/4	0560084055	1	2 <sup>13</sup> / <sub>16</sub>	1/4	1 1/8	1 1/8	5 1/2	50	300	5
1	0560084063	1 1/4	3 1/4	1/4	1 1/8	1 1/2	6	50	300	6
1 1/4	0560084071	1 5/16	3 3/8	1/4	1 1/8	1 11/16	6 1/2	50	150	7
1 1/2	0560084089	1 9/16	3 3/8	1/4	1 1/8	2 1/8	7	50	100	8
2	0560084097	1 13/16	4 5/16	1/4	1 1/8	2 9/16	8	50	100	9

# Figure 187 - Two Hole 90° Side Mount Strap

**Size Range:** 3/4" through 2"

**Finish:** Galvanized steel

**Service:** Hanger for CPVC pipe in the horizontal position on the bottom of structural wood beams and Steel 20 Ga. (min.) (Fig. A). *Can be used as a restrainer, only in Steel 20 Ga. (min) (Fig. B).* During installation, adjust hanger mounting flanges such that pipe contacts both mounting surface and hanger, minimizing vertical pipe movement.

**Approvals:** UL listed.

**Features:**

- Beveled edge design helps protect the CPVC pipe from any rough surface.
- Easily attaches to wood structure with #10 x 1" hex washer head self threading screw supplied with product. No pre-drilling required.

**Ordering:** Specify CPVC pipe size, figure number and description.

- Steel applications require two (2) #14 x 1" hex washer head self-drilling TEK screws. Not Supplied. Part Number STD-0090.

**Installation:**

- Snap hanger over pipe. Dimples will prevent hanger from falling off pipe.
- Secure hanger to mounting surface with screws provided.
- Do not anchor tightly to mounting surface. Pipe must be allowed to move freely through hanger.

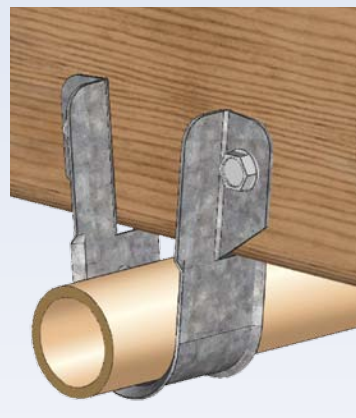
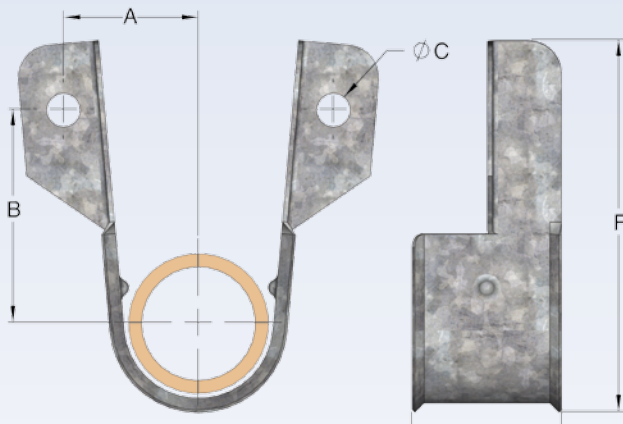

Fig. A

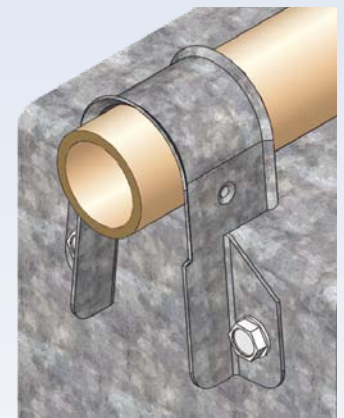

Fig. B

**FIG. 187: WEIGHT (LBS) • DIMENSIONS (IN)**

CPVC Pipe Size	Item Number	A	B	øC	E	F	Max. Hanger Spacing (FT.)	Box Quantity		Approx. Weight/100 (lbs)
								Small	Master	
3/4	0560084105	1	1 1/2	1/4	1 1/8	2 3/4	5 1/2	50	200	5
1	0560084113	1 1/8	1 1/2	1/4	1 1/8	2 13/16	6	50	150	6
1 1/4	0560084121	1 5/8	1 3/4	1/4	1 1/8	3 1/4	6 1/2	50	150	7
1 1/2	0560084139	1 1/2	1 7/8	1/4	1 1/8	3 1/2	7	50	100	8
2	0560084147	1 3/4	2	1/4	1 1/8	3 7/8	8	50	100	9

# Figure 188 - Two Hole Stand Off Strap

**Size Range:** 3/4" through 2"

**Finish:** Galvanized steel

**Service:** Support for CPVC pipe off the face of structural wood beams (Fig. A) eliminates the use of back-up blocks. It can also be used as a hanger for CPVC pipe in the horizontal position on the bottom of structural wood beams and Steel 20 Ga. (min.) (Fig. B).

**Approvals:** UL listed.

**Features:**

- Beveled edge design helps protect the CPVC pipe from any rough surface.
- Easily attaches to wood structure with #10 x 1" hex washer head self threading screw supplied with product. No pre-drilling required.
- Eliminates wooden spacer blocks.

**Ordering:** Specify CPVC pipe size, figure number and description.

- Steel applications require two (2) #14 x 1" hex washer head self-drilling TEK screws. Not Supplied. Part Number STD-0090.

**Installation:**

- Snap hanger over pipe.
- Position hanger back around pipe but allow for pipe movement.
- Secure hanger to mounting surface with screws provided. Recheck to insure that the pipe is allowed to move freely through hanger.

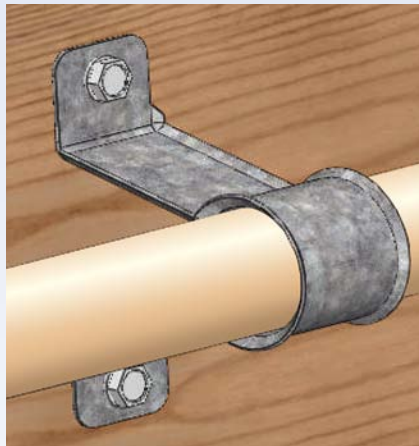
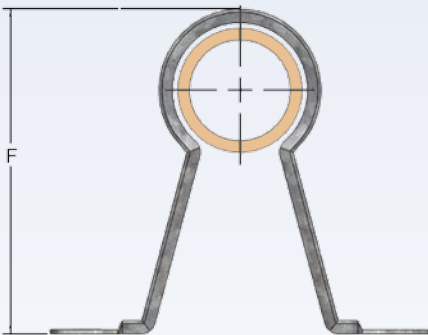
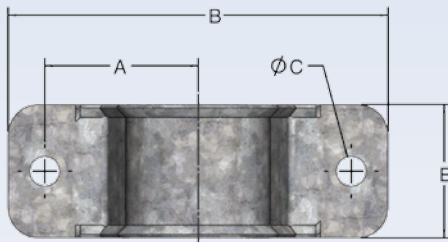

Fig. A

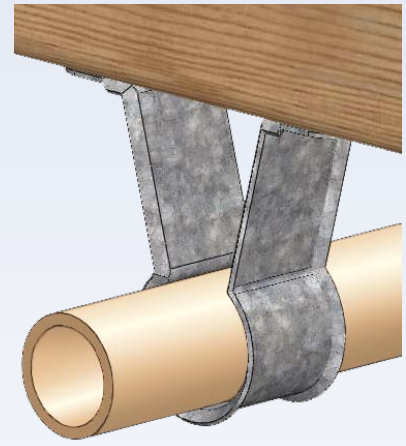

Fig. B

**FIG. 188: WEIGHT (LBS) • DIMENSIONS (IN)**

CPVC Pipe Size	Item Number	A	B	øC	E	F	Max. Hanger Spacing (FT.)	Box Quantity		Approx. Weight/100 (lbs)
								Small	Master	
3/4	0560084154	1 5/16	3 3/4	1/4	1 1/8	2 3/4	5 1/2	50	150	5
1	0560084162	1 3/8	3 3/8	1/4	1 1/8	3	6	50	100	6
1 1/4	0560084170	1 1/2	3 1 1/16	1/4	1 1/8	3 5/16	6 1/2	50	100	7
1 1/2	0560084188	1 7/8	4 3/8	1/4	1 1/8	3 9/16	7	25	75	8
2	0560084196	2	4 1/2	1/4	1 1/8	4 1/8	8	25	50	9

# BRANDS OF ANVIL INTERNATIONAL



Anvil® product lines include malleable and cast iron fittings, unions and flanges; seamless steel pipe nipples; steel pipe couplings; universal anvilets; forged steel fittings and unions; pipe hangers and supports; threaded rod; and engineered hangers.



The Gruvlok® product line consists of couplings for grooved and plain-end fittings, butterfly valves and check valves; flanges; pump protection components; pipe grooving tools; as well as copper and stainless steel system components.



The SPF/Anvil™ product line includes a variety of internationally sourced products such as grooved couplings, fittings and flanges, cast iron, malleable iron and ductile iron threaded fittings, steel pipe nipples, as well as o'lets.



Beck steel pipe nipples and steel pipe couplings are manufactured in accordance with the ASTM A733 Standard Specification for Welded and Seamless Carbon Steel and Stainless Steel Pipe Nipples. Steel pipe couplings are manufactured in accordance with the ASTM A865 Standard Specification for Threaded Couplings, Steel, Black or Zinc-Coated (Galvanized) Welded or Seamless, for Use in Steel Pipe Joints. Beck API couplings are manufactured in accordance with the API Specification for line pipe.



Anvil-Strut™ products include a complete line of channel in stock lengths of 10 and 20 feet, with custom lengths available upon request. A variety of fittings and accessories are also offered. All products can be ordered in an assortment of finishes and material choices including SupR-Green™, Zinc Trivalent Chromium, pre-galvanized, hot-dipped galvanized, electro-galvanized, aluminum, plain, and stainless steel.



AnvilStar™ offers a complete line of products for the fire protection industry, including Gruvlok® couplings, fittings, flanges; valves, and roll groovers; steel pipe nipples and couplings; cast and malleable iron threaded and flanged fittings; pipe hangers and supports; Merit® tee-lets, drop nipples; steel welding flanges; SPF grooved couplings, fittings, and flanges; SPF cast iron and ductile iron threaded fittings, o'lets, steel pipe nipples; and Mueller valves and indicator posts.



JB Smith™ is the leading manufacturer of oil country tubular fittings, swages and bull plugs – all meeting API specifications. Offering tubing nipples, casing nipples as well as a full line of traditional line pipe and oil country threads in every schedule, JB Smith is the resource for all your oilfield needs.



The Merit® product line includes a variety of tee-lets, drop nipples, and steel welding flanges for fire protection applications. Most Merit products are UL/ULC Listed, FM Approved, and rated from 175 to 300 psi.



Catawissa™ NACE and API approved wing unions for Standard and Sour Gas Service are offered in non-pressure seal ends as well as threaded and butt weld, and are interchangeable with most leading union manufacturers. Fully traceable and available with complete mill certifications, Catawissa's oilfield wing union product line includes the standard ball-and-cone design plus our unique Figure 300 Flat Face design, where space and pipe line separation are a consideration.



Canvil® manufactures low pressure hexagon reducer bushings, as well as plugs and hex caps up to 1" in diameter in various finishes including Oil Treat, Phosphate and Electro Galvanized. In addition, Canvil manufactures A105 hex or round material in class 3000 and 6000 pound, forged steel couplings and bar stock products offered as either as normalized (A105N) or non-normalized (A105) that are fully traceable for mechanicals and chemistry through our MTR program.



### Corporate Offices

110 Corporate Drive, Suite 10  
P.O. Box 3180  
Portsmouth, NH 03802-3180  
Tel: 603-422-8000  
Fax: 603-422-8033  
E-mail: [webmaster@anvilintl.com](mailto:webmaster@anvilintl.com)

### Anvil International Worldwide Customer Service Center

Tel: 708-885-3000  
Fax: 708-534-5441

## U.S. REGIONAL SERVICE CENTERS

### Eastern Region

**SERVICING:** Connecticut, Delaware, Florida, Georgia, Maine, Maryland, Massachusetts, New Hampshire, New Jersey, New York, North and South Carolina, East Pennsylvania, Rhode Island, Vermont, Virginia

800 Malleable Road  
Columbia, PA 17512

Tel: 708-885-3000  
Fax: 708-534-5441  
Toll Free: 1-800-301-2701

### Northern Region

**SERVICING:** Illinois, Indiana, Iowa, Kentucky, Michigan, Minnesota, Nebraska, North and South Dakota, Ohio, West Pennsylvania, West Virginia, Wisconsin

750 Central Avenue  
University Park, IL 60466

Tel: 708-885-3000  
Fax: 708-534-5441  
Toll Free: 1-800-301-2701

### Southern Region

**SERVICING:** Alabama, Arkansas, Kansas, Louisiana, Mississippi, Missouri, Oklahoma, Tennessee, Texas

1313 Avenue R  
Grand Prairie, TX 75050

Tel: 972-343-9206  
Fax: 972-641-8946  
Toll Free: 1-800-451-4414

### Western Region

**SERVICING:** Alaska, Arizona, California, Colorado, Hawaii, Idaho, Montana, Nevada, New Mexico, Oregon, Utah, Washington, Wyoming

1385 Greg Street  
Sparks, NV 89431

Tel: 775-331-7029  
Fax: 775-331-5075  
Toll Free: 1-800-572-0051

## CANADA SERVICE CENTERS

### Anvil International Canada

#### Corporate

Michael J. Warne, General Manager  
[mwarne@anvilintl.com](mailto:mwarne@anvilintl.com)

390 Second Avenue  
P.O. Box 40  
Simcoe, Ontario N3Y 4K9

Tel: 519-426-4551  
Fax: 519-426-5509

#### Quebec & Atlantic

2625 Brabant Marineau  
St. Laurent, Quebec H4S 1R8

Tel: 514-745-3835  
Fax: 514-745-9079  
Toll Free: 1-800-661-8998

#### Ontario

390 Second Avenue  
P.O. Box 40  
Simcoe, Ontario N3Y 4K9

Tel: 519-426-4551  
Fax: 519-426-5509  
Toll Free: 1-800-661-8998

#### Manitoba, Saskatchewan, Alberta & British Columbia

5506-48 St. NW  
Edmonton, Alberta T6B 2Z1

Tel: 780-413-8274  
Fax: 780-413-8298  
Toll Free: 1-800-661-8998

## INTERNATIONAL SALES

### Europe and Middle East Region

Rick van Meesen, Sales Director  
[rvanmeesen@anvilintl.com](mailto:rvanmeesen@anvilintl.com)

Tormentil 15  
7483 BR Haaksbergen  
The Netherlands

Tel: +31-53-5725570  
Fax: +31-53-5725579

U.S. Customer Service  
Tel: +1-708-885-3000  
Fax: +1-708-534-5441

### Mexico, Puerto Rico and Latin America

Abraham Quijada, Sales Manager

Tel: +1-281-590-4600

U.S. Customer Service  
Tel: +1-708-885-3000  
Fax: +1-708-534-5441

BUILDING CONNECTIONS THAT LAST



[www.anvilintl.com](http://www.anvilintl.com)

#155/Printed in USA/RPI/5M/© Copyright 2009  
Revision Date: 2.20.09